

## MODEL CRT-B SPECIFICATION

Single rope sensor designed to be used on the elevator 8-14mm ropes.



### Metrology and Electrical Specifications

Rated Output	2 +/- 0.02%	mV/V
Zero Balance	+/- 1%	rated load
Total Error	0.5	rated load
Nominal input voltage	10	load
Maximum input voltage	15	VV
Input resistance	380 +/- 20	ohms
Output resistance	352 +/- 3	ohms

### Product Description

The rope sensor system combines an alloy steel sensor with three steel pins for fixing to a single elevator rope. Simple installation makes them ideal for retrofit applications.

### General Specifications

Overload	150	% rated load
Ultimate load	200	% rated load
Temperature range	-30 to +70	C
Protection	IP65	
Material	Steel Alloy	

### Rope Sensor

Alloy steel construction  
Suitable for rope sizes 8mm - 14mm  
Ease of installation

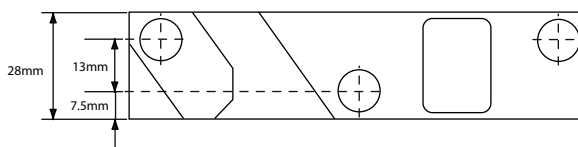
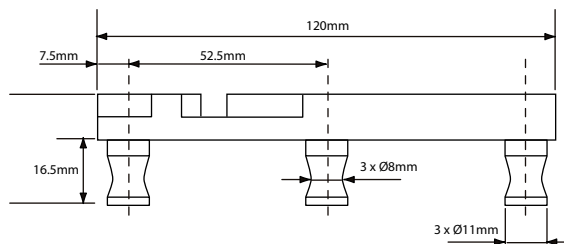
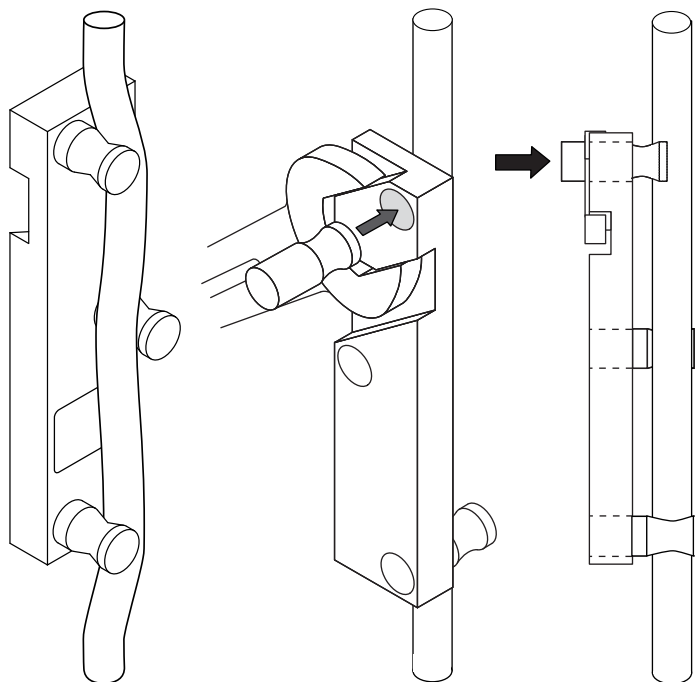
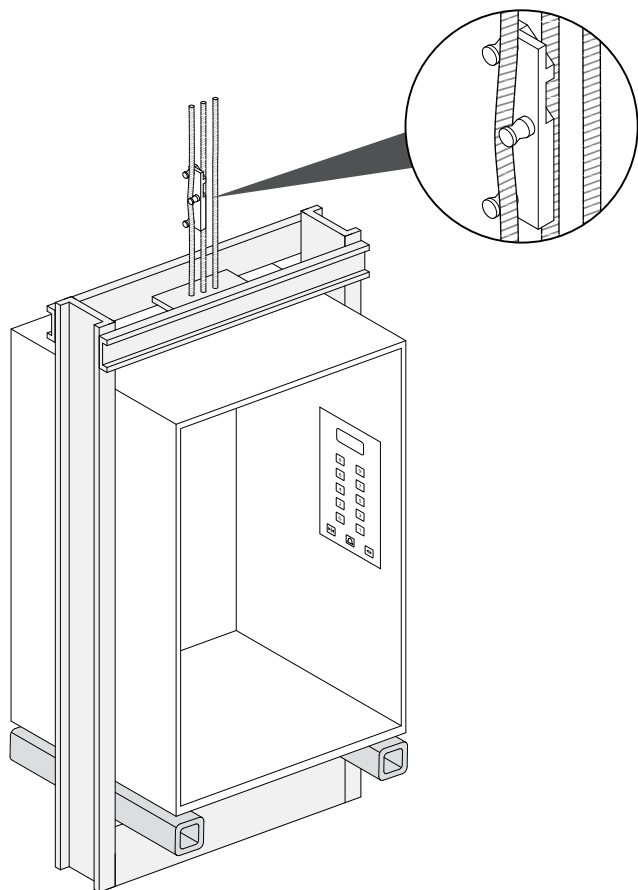

## Wiring Schematic Diagram

